

Welcome to the East Area Planning Committee

- This planning committee meeting is held in public but it is not a public meeting.
- There will be an opportunity for the public to address the committee on each application.
- If you wish to speak for or against a planning application, you need to have either requested it in advance, or hand in one of the available speaker forms, or speak to the clerk.
- Information on meeting protocol and conduct at the committee is set out in the Code of Practice.
- This is in the committee agenda just before the first planning application report.



Site Location Plan

42



www.oxford.gov.uk



View of Site from Cowley Road

www.oxford.gov.uk

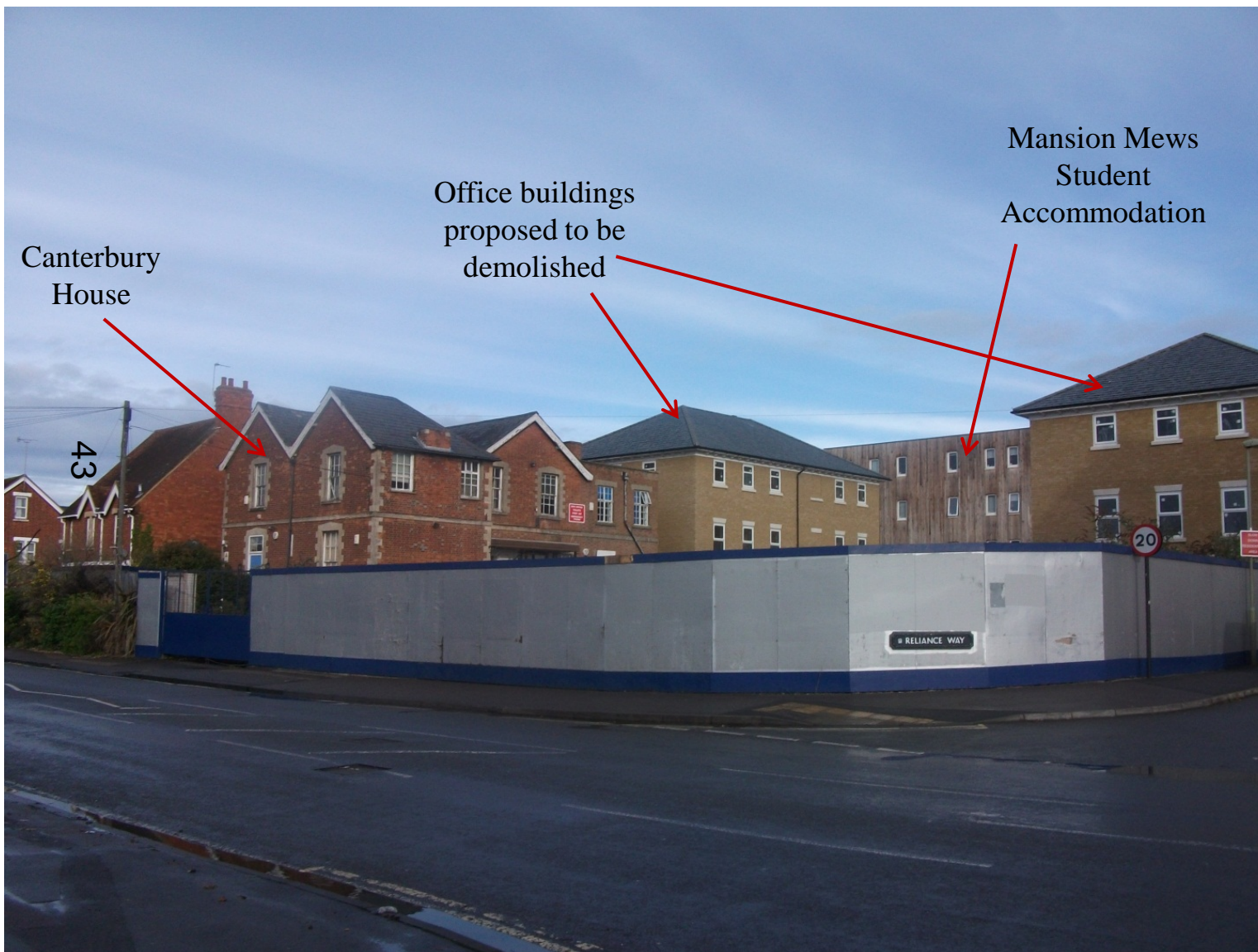

View of Site from Reliance Way

www.oxford.gov.uk



The Site as viewed from Glanville Road

Mansion Mews
Student
Accommodation

Existing office
building on the site



www.oxford.gov.uk



View from Cowley Road across to Reliance Way

www.oxford.gov.uk



View within the Site looking towards Cowley Road





Rivera House (Proposed
to be demolished)

www.oxford.gov.uk



Indicative Proposed Site Layout

49

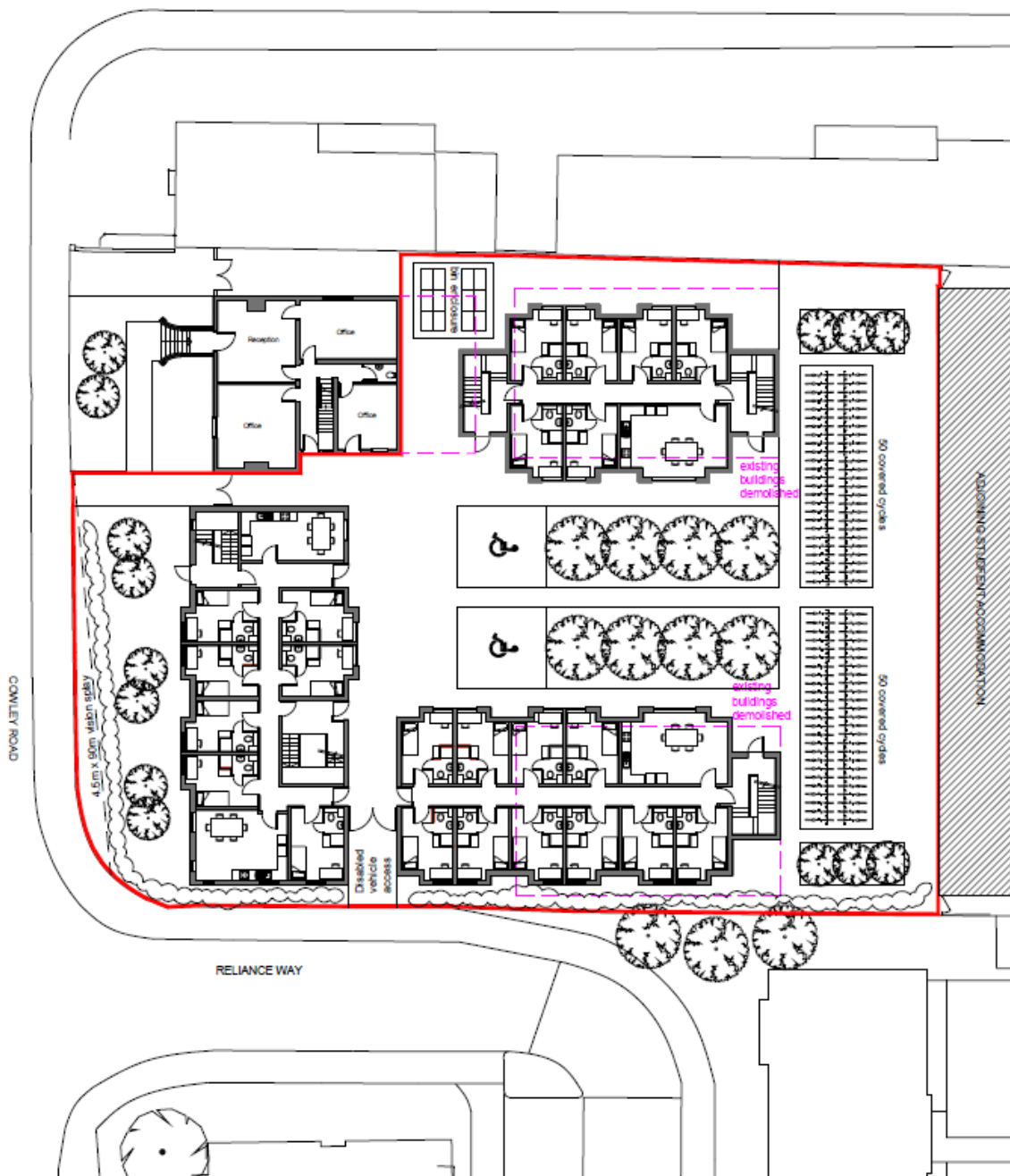

Indicative Visualisations



INDICATIVE VIEW OF CORNER COWLEY ROAD WITH RELIANCE WAY



INDICATIVE VIEW OF RELIANCE WAY JUNCTION WITH COWLEY ROAD

Further Indicative Visualisations

www.oxford.gov.uk



INDICATIVE VIEW OF CORNER COWLEY ROAD WITH GLANVILLE RD



INDICATIVE VIEW FROM COWLEY ROAD



Indicative Proposed Street Elevations

www.oxford.gov.uk



INDICATIVE ELEVATION TO COWLEY ROAD (1:200)



INDICATIVE ELEVATION TO RELIANCE WAY (1:200)

